

除非同意，严禁复制、散发、披露或以此文件及其中内容进行买卖交易。任何违背此条
令者需承担全部法律责任。保留所有权利，特别是专利权和已注册的设计所有权。

Unless it has been agreed otherwise, it is strictly forbidden to copy, distribute,
disclose or trade this document or its contents. Anybody in breach of this ban
will be held liable for full compensation. All rights reserved, especially
the right for patent or registered design lodgement.

借(通)用件登记

旧底图总号

底图总号

签 字

日 期

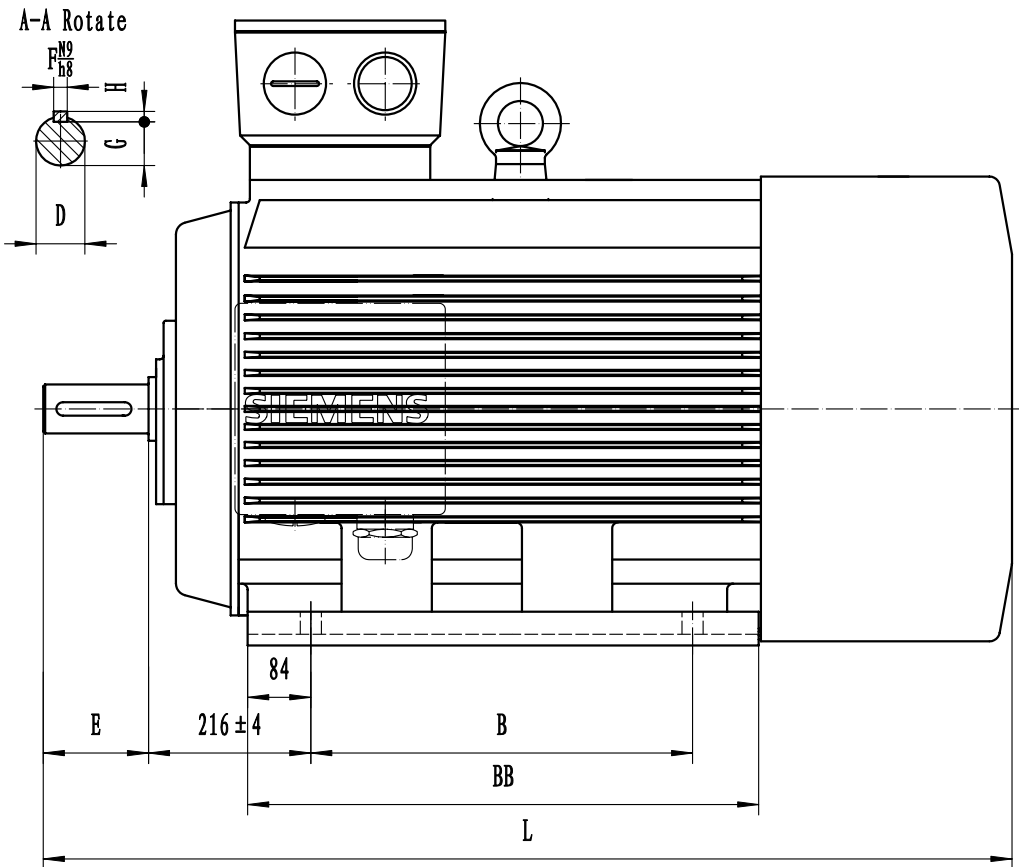

Type	Power (kW)	B	D	E	F	H	G	BB	L
1LG0310-2AC	110	406	$\phi 65^{+0.030}_{+0.011}$	140 ± 0.5	18	$11^{0}_{-0.11}$	$58^{0}_{-0.20}$	570	1190
1LG0313-2AC	132	457						680	1300
1LG0316-2AC	160	508							
1LG0317-2AC	200								
1LG0310-4AB	110	406	$\phi 80^{+0.030}_{+0.011}$	170 ± 0.5	22	$14^{0}_{-0.11}$	$71^{0}_{-0.20}$	570	1220
1LG0313-4AB	132	457						680	1330
1LG0316-4AB	160	508							
1LG0317-4AB	200								
1LG0310-6AB	75	406	508					570	1220
1LG0313-6AB	90	457							
1LG0316-6AB	110	508						680	1330
1LG0317-6AB	132								

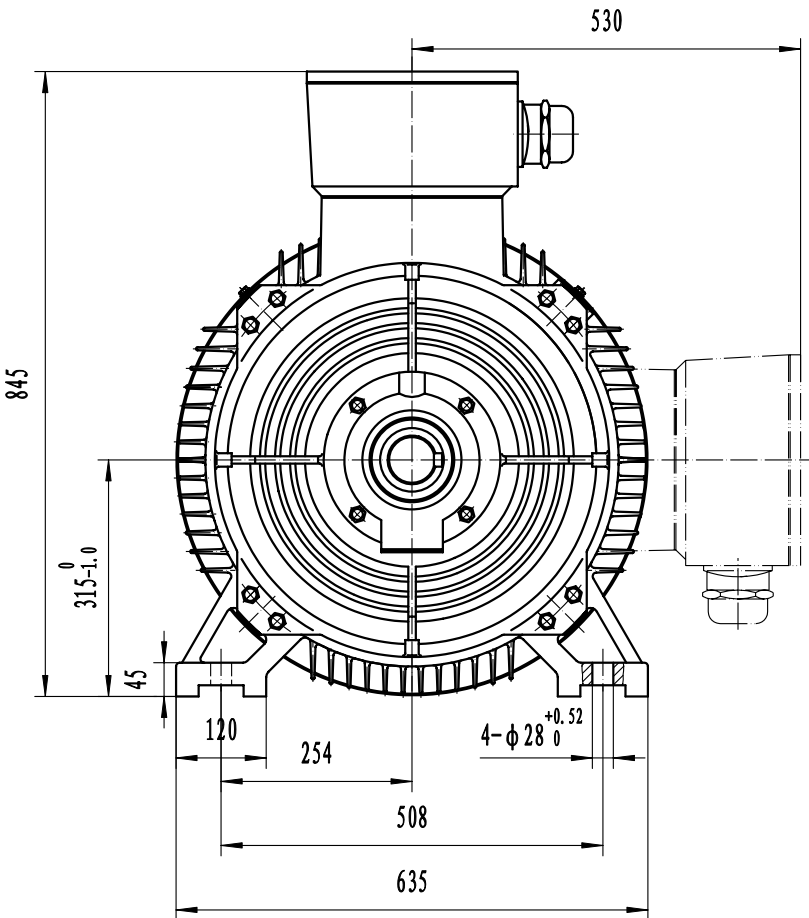

注：电机（指实物）安装尺寸符合图中尺寸，外形尺寸不大于图中尺寸。

Note: Dimensions of mounting shall accord with drawing's dimensions, outline
dimensions shall not exceed the drawing's dimensions.

							Siemens Standard Motors Ltd.		
							1LG0-315 (B3)		
标记	处数	分区	更改文件号	签名	日期		阶段标记	重量	比例
设计	孙梅	20080721	标准化						1:7
校对			审定						
审核	王庆中	20080722							
工艺			批准				共	张	第 张